

## B - M

- Tuerca
- Serie L y S
- Rosca Métrica
  
- Nut
- L and S Series
- Thread: Metric parallel

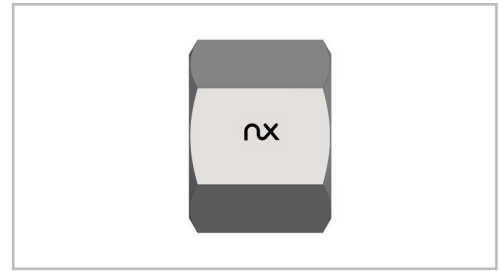
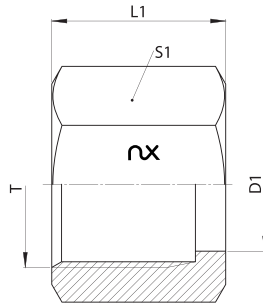

B - M							
Serie Series	D1 mm	T	L1 mm	S1 mm	PN bar	Serie Name	Artículo N° Article No.
L/S	18	M 22 x 1,5	23	27	630	ST B-M 15 L / 14 S	10217410
	24	M 30 x 2	28	36	420	ST B-M 22 L / 20 S	10217412
L	8	M 12 x 1,5	17	14	500	ST B-M 06 L	10217271
	10	M 14 x 1,5	18	17	500	ST B-M 08 L	10217274
	12	M 16 x 1,5	20	19	400	ST B-M 10 L	10217277
	14	M 18 x 1,5	21	22	400	ST B-M 12 L	10213425
	21	M 26 x 1,5	23	32	400	ST B-M 18 L	10217411
	30	M 36 x 2	28	41	250	ST B-M 28 L	10216025
	38	M 45 x 2	30	50	250	ST B-M 35 L	10217414
	45	M 52 x 2	34	60	250	ST B-M 42 L	10217415
S	8	M 14 x 1,5	18	17	800	ST B-M 06 S	10217406
	10	M 16 x 1,5	19	19	800	ST B-M 08 S	10217407
	12	M 18 x 1,5	21	22	630	ST B-M 10 S	10217408
	14	M 20 x 1,5	21	24	630	ST B-M 12 S	10217409
	19	M 24 x 1,5	27	30	630	ST B-M 16 S	10217282
	29	M 36 x 2	31	46	420	ST B-M 25 S	10217285
	34	M 42 x 2	32	50	420	ST B-M 30 S	10217413
	42	M 52 x 2	38	60	420	ST B-M 38 S	10217287